

ROYAL CENTRE RETAIL

Floor Plans

R1 - Upper



R2 - Lower

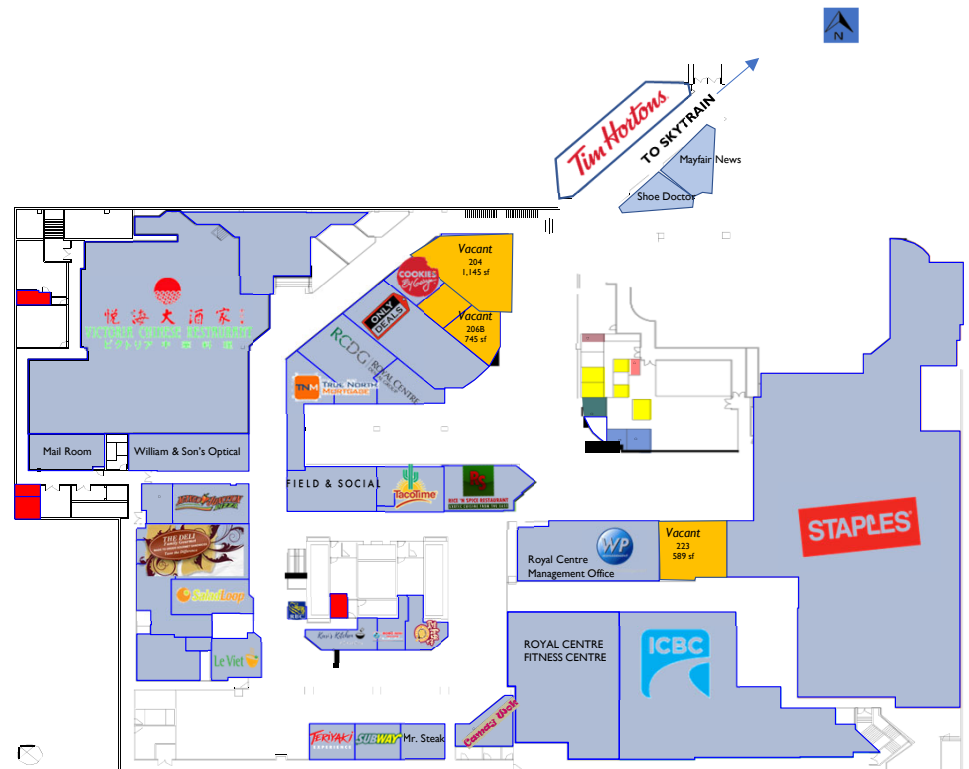

PROUDLY MANAGED BY



Warrington PCI Management

ROYAL CENTRE

1055 WEST GEORGIA STREET, VANCOUVER, BC

GROSS LEASABLE

Retail	152,936 SF
Office	475,392 SF
TOTAL	628,328 SF